

PLAT OF SURVEY

LOT 142, STERLING OAKS ADDITION NO. 1, being a part of the Northwest 1/4 and Southwest 1/4 of the Northeast 1/4 and a part of the Northeast 1/4 and Southeast 1/4 of the Northwest 1/4, all in Section 20, Town 4 North, Range 18 East, Village of East Troy, Walworth County, Wisconsin.

Surveyed for: Bielinski Bros. Builders Inc./Mark and Betsy Flynn

Suggested yard grade per grading plan: 856.5

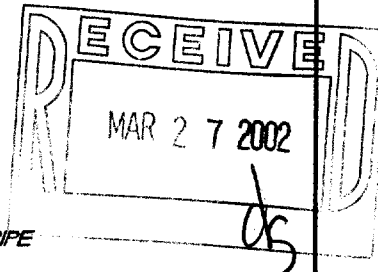
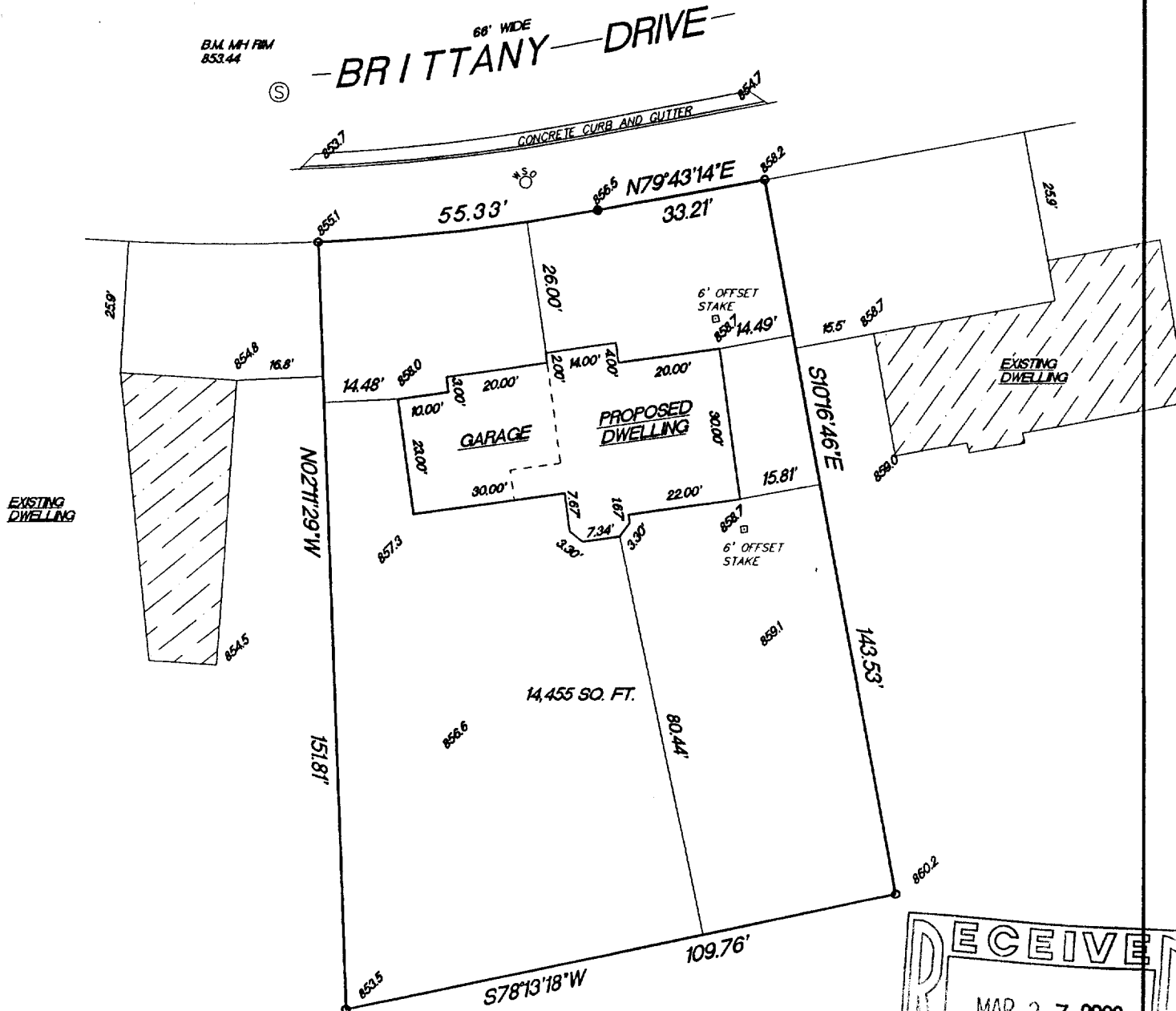

- FOUND 2" IRON PIPE
- FOUND 1" IRON PIPE
- 860.2 EXISTING SPOT ELEVATIONS

RADIUS	LENGTH	CHORD	BEARING	DELTA
391.97'	55.33'	55.29'	N83°45'52.5"E	08°05'17"

"I hereby certify that I have surveyed the above described property and that the above map is a true representation thereof and shows the size and location of the property, its exterior boundaries, the location of all visible structures and dimension of all principal buildings thereon, boundary fences, apparent easements, roadways and encroachments if any."

"This survey is made for the use of the present owners of the property, and also those who purchase, mortgage or guarantee the title thereto within one year from date hereof."

KETTLE MORaine SURVEYING
W356 S9050 Godfrey Lane
Eagle Wisconsin 53119
P.O. Box 357
(262) 594-3484

Terrance E. Pisarek R.L.S.



THIS IS NOT AN ORIGINAL SURVEY UNLESS THE SEAL IS RED.

1/29/02

DATE

TEP/DW

FIELD WORK BY

TEP

DRAWN BY

02011

JOB NUMBER

RST01-721 003-804